



City Council
April 2, 2019

Addendum #1
Items Received at the Meeting

EXTERIOR LUMINAIRE SCHEDULE								
LUMINAIRE DESIGNATION	MANUFACTURER	MODEL	DESCRIPTION	LUMINAIRE LUMENS	LUMINAIRE WATTS	CCT	DRIVER TYPE	VOLTS
E1	IGUZZINI	ILM-HO-FL-L3-LENGTH-M2-15	EXTERIOR WALL MOUNTED 3 FT DOWNLIGHT WITH REMOTE DRIVER UL WET LOCATION LISTED.	460	11	3000K	NON-DIM	277 V
E2	IGUZZINI	ILM-HO-FL-L3-LENGTH-M2-15	EXTERIOR WALL MOUNTED 6 FT DOWNLIGHT WITH REMOTE DRIVER UL WET LOCATION LISTED.	920	11	3000K	NON-DIM	277 V
E3	WEEF	661-5140	EXTERIOR POLE MOUNTED, SINGLE HEAD FULL CUTOFF LED AREA LUMINAIRE WITH INTEGRAL ELECTRONIC DRIVER, UL LISTED WET LOCATION LISTED, TYPE III IESNA DISTRIBUTION, MOUNT AT 14'-0" ABOVE GRADE TO TOP OF LUMINAIRE. LUMINAIRE TO BE MOUNTED AT 14 FT AFF. USE THE MANUFACTURER "VALMONT" FOR LIGHT POLE MODEL #: DS330-4000140-D1-FP-(F) NISH TO MATCH EXISTING)-FBC-AB.	2653	28	3000K	NON-DIM	277 V
E4	WEEF	661-6528	EXTERIOR POLE MOUNTED, SINGLE HEAD FULL CUTOFF LED AREA LUMINAIRE WITH INTEGRAL ELECTRONIC DRIVER, UL LISTED WET LOCATION LISTED, TYPE III IESNA DISTRIBUTION, MOUNT AT 14'-0" ABOVE GRADE TO TOP OF LUMINAIRE. LUMINAIRE TO BE MOUNTED AT 20 FT AFF. USE THE MANUFACTURER "VALMONT" FOR LIGHT POLE MODEL #: DS330-4000200-D1-FP-(F) NISH TO MATCH EXISTING)-FBC-AB.	5000	48	3000K	NON-DIM	277 V
E5	WEEF	CFY259	EXTERIOR BOLLARD MOUNTED FULL CUTOFF DOWNLIGHT WITH INTEGRAL DRIVER, UL WET LOCATION LISTED.	690	27	3000K	NON-DIM	277 V
E5A	WEEF	VAR-CFY259	EXTERIOR BOLLARD MOUNTED FULL CUTOFF DOWNLIGHT WITH INTEGRAL DRIVER AND GFCI OUTLET IN BASE. UL WET LOCATION LISTED.	690	27	3000K	NON-DIM	277 V
E6	BK LIGHTING	DE-LED-X8 6-SF-FINIS H-9-11-A	EXTERIOR FLAG POLE LUMINAIRES, 6-7 SETBACK NEEDED FROM FINAL POLE LOCATIONS, TO BE COORDINATED BY ARCHITECT.	1923	27	3000K	NON-DIM	277 V
EX1	N/A	N/A	EXISTING EXTERIOR LUMINAIRE AND POLE TO REMAIN. FIXTURE TO REMAIN POWERED BY EXISTING BUILDING POWER SOURCE. RECONNECT AS REQUIRED.	N/A	N/A	N/A	N/A	277 V
EX2	N/A	N/A	EXISTING EXTERIOR LUMINAIRE AND POLE TO REMAIN. FIXTURE TO REMAIN POWERED BY EXISTING BUILDING POWER SOURCE. RECONNECT AS REQUIRED.	N/A	N/A	N/A	N/A	277 V
EX3	N/A	N/A	EXISTING EXTERIOR LUMINAIRE AND POLE TO REMAIN. FIXTURE TO REMAIN POWERED BY EXISTING BUILDING POWER SOURCE. RECONNECT AS REQUIRED.	N/A	N/A	N/A	N/A	277 V

Calculation Summary		
Label	CalcType	Avg
BUILDING ENTRANCES	Illuminance	5.66
PARKING LOT	Illuminance	1.99
SIGNALS	Illuminance	2.17

THE BUSINESS CENTER AT C.T.C.
REPLAT H, LOTS 3A AND 4A
 152 S TAYLOR AVE AND 194 S TAYLOR AVE
 FINAL PLANNED UNIT DEVELOPMENT
 LOCATED IN THE NORTH HALF QUARTER OF SECTION 16,
 TOWNSHIP 1 SOUTH, RANGE 69 WEST OF THE 6TH P.M.
 CITY OF LOUISVILLE, COUNTY OF BOULDER, STATE OF
 COLORADO

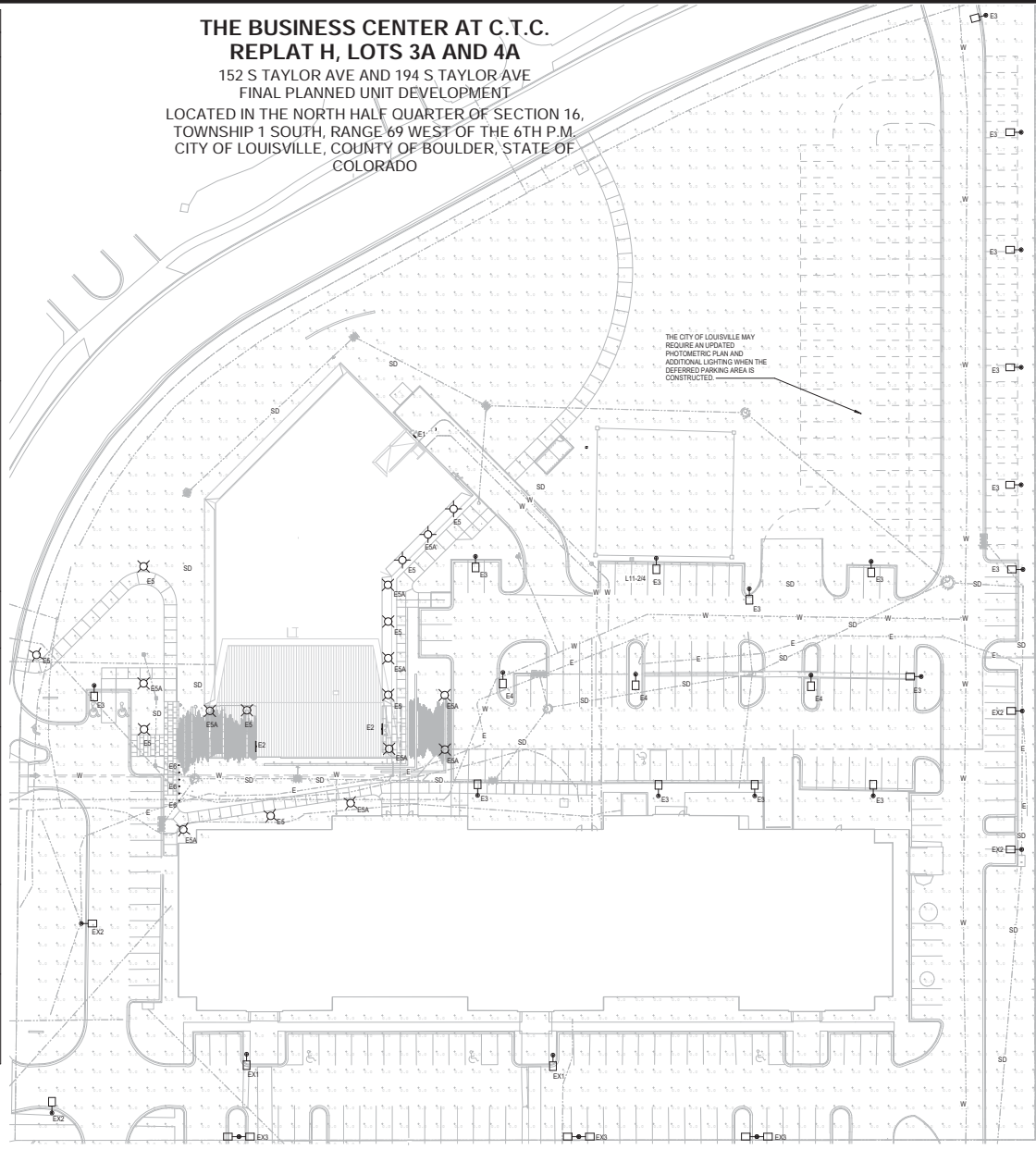

1 SITE LIGHTING AND PHOTOMETRIC PLAN
1" = 30'-0"

3003 Larimer St
 Denver, CO 80205
 phone 303.963.6764
 1315 Spoons Street
 Boulder, CO 80502 303.444.1951

DATE: 12-26-18
 SCALE: AS NOTED
 FILE NAME: FINAL LUD
 SHEET: 16 OF 18

THE BUSINESS CENTER AT CTC, REPLAT H
 SITE LIGHTING AND PHOTOMETRIC PLAN